

DHP

SK-DHP Hydraulic Chuck
SK-DHP 液壓刀柄

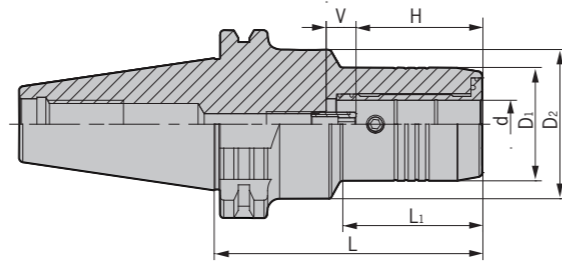

MAX
30,000
min⁻¹

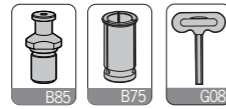

NEW

型號 Specification	d	D1	D2	L1	L	H	V	T	適用筒夾 Suit collet	扳手 Wrench	重量 Weight
SK30- DHP6-65	6	28	50	23	65	27.5	10	M5X0.8	-	T04	1.26
DHP6-80.5	6	28	50	44	80.5	27.5	10	M5X0.8	-	T04	1.35
DHP6-110	6	28	50	44	110	27.5	10	M5X0.8	-	T04	1.77
DHP8-65	8	30	50	23	65	27.5	10	M6X1.0	-	T04	1.26
DHP8-80.5	8	30	50	44	80.5	27.5	10	M6X1.0	-	T04	1.38
DHP8-110	8	30	50	44	110	27.5	10	M6X1.0	-	T04	1.84
DHP10-65	10	32	50	23	65	32.5	10	M6X1.0	-	T04	1.28
DHP10-80.5	10	32	50	44	80.5	32.5	10	M6X1.0	-	T04	1.40
SK40- DHP10-110	10	32	50	44	110	32.5	10	M6X1.0	-	T04	1.95
DHP12-65	12	34	50	23	65	37.5	10	M6X1.0	D12/OD12	T04	1.28
DHP12-80.5	12	34	50	44	80.5	37.5	10	M6X1.0	D12/OD12	T04	1.45
DHP12-110	12	34	50	44	110	37.5	10	M6X1.0	D12/OD12	T04	2.00
DHP14-75	14	36	50	30	75	37.5	10	M6X1.0	-	T04	1.40
DHP14-80.5	14	36	50	44	80.5	37.5	10	M6X1.0	-	T04	1.49
DHP14-110	14	36	50	44	110	37.5	10	M6X1.0	-	T04	2.02
DHP16-75	16	38	50	30	75	42.5	10	M8X1.0	-	T04	1.44
DHP16-80.5	16	38	50	48	80.5	42.5	10	M8X1.0	-	T04	1.55
DHP16-110	16	38	50	48	110	42.5	10	M8X1.0	-	T04	2.21
DHP18-75	18	41	50	30	75	42.5	10	M8X1.0	-	T04	1.48
DHP18-80.5	18	41	50	48	80.5	42.5	10	M8X1.0	-	T04	1.58
DHP18-135	18	41	50	48	110	42.5	10	M8X1.0	-	T04	2.65
DHP20-75	20	43	50	30	75	42.5	10	M8X1.0	D20/OD20	T04	1.40
DHP20-80.5	20	43	50	48	80.5	42.5	10	M8X1.0	D20/OD20	T04	1.65
DHP20-135	20	43	50	48	135	42.5	10	M8X1.0	D20/OD20	T04	2.70
DHP25-80.5	25	57	66	26	80.5	51	10	M16X1.0	-	T05	2.00
DHP32-80.5	32	63	80	26	80.5	55	10	M16X1.0	D32/OD32	T05	2.20

轉下頁
See next page

DHP

SK-DHP Hydraulic Chuck
SK-DHP 液壓刀柄



MAX
30,000
min⁻¹

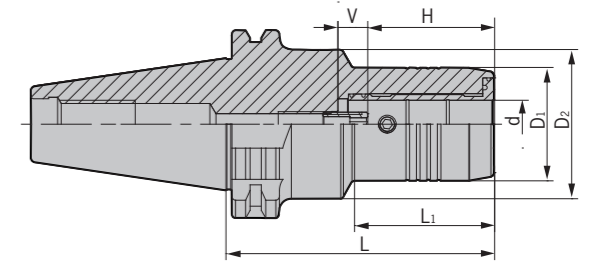
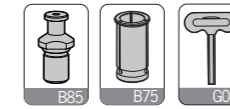

NEW

型號 Specification	d	D1	D2	L1	L	H	V	T	適用筒夾 Suit collet	扳手 Wrench	重量 Weight
SK50- DHP6-90	6	28	50	44	90	27.5	10	M5X0.8	-	T04	4.03
DHP6-140	6	28	50	44	140	27.5	10	M5X0.8	-	T04	4.65
DHP8-90	8	30	50	44	90	27.5	10	M6X1.0	-	T04	4.06
DHP8-140	8	30	50	44	140	27.5	10	M6X1.0	-	T04	4.68
DHP10-90	10	32	50	44	90	32.5	10	M6X1.0	-	T04	4.08
DHP10-140	10	32	50	44	140	32.5	10	M6X1.0	-	T04	4.71
DHP12-90	12	34	50	44	90	37.5	10	M6X1.0	D12/OD12	T04	4.09
DHP12-140	12	34	50	44	140	37.5	10	M6X1.0	D12/OD12	T04	4.73
DHP14-90	14	36	50	47	90	37.5	10	M6X1.0	-	T04	4.10
DHP14-140	14	36	50	47	140	37.5	10	M6X1.0	-	T04	4.75
DHP16-90	16	38	50	48	90	42.5	10	M8X1.0	-	T04	4.12
DHP16-140	16	38	50	48	140	42.5	10	M8X1.0	-	T04	4.81
DHP18-90	18	41	50	48	90	42.5	10	M8X1.0	-	T04	4.14
DHP18-140	18	41	50	48	140	42.5	10	M8X1.0	-	T04	4.85
DHP20-80.5	20	43	50	44	80.5	42.5	10	M8X1.0	D20/OD20	T04	4.11
DHP20-90	20	43	50	48	90	42.5	10	M8X1.0	D20/OD20	T04	4.35
DHP20-110	20	43	50	48	110	42.5	10	M8X1.0	D20/OD20	T04	4.65
DHP20-140	20	43	50	48	140	42.5	10	M8X1.0	D20/OD20	T04	4.95
DHP25-105	25	57	-	85.9	105	51	10	M16X1.0	-	T05	4.60
DHP25-140	25	57	-	120.9	140	51	10	M16X1.0	-	T05	5.40
DHP32-115	32	63	-	95.9	115	55	10	M16X1.0	D32/OD32	T05	4.85
DHP32-140	32	63	-	120.9	140	55	10	M16X1.0	D32/OD32	T05	5.67

注：報價含扳手，筒夾需單獨訂購。
Notice: Wrench is included, while collet shall be ordered separately.

特點 / Feature

- DHP 刀具系列用途高轉速、高精密切削加工，切削效果佳。
- 動平衡設定：G2.5; 20,000 rpm。
- 3D 處徑向跳動 0.003 mm。
- For high-speed and high precision cutting;
- Balanced: G2.5; 20,000 rpm;
- Runout (X3D): < 0.003 mm.

加工中心刀柄
ISO holder

SK 刀柄
SK holder

BT 刀柄
BT holder

SK 刀柄
SK holder

ISO 刀柄
ISO holder

刀柄配件
holder accessories

加工中心刀柄
TOOL HOLDERS

ISO 刀柄
ISO holder

BT 刀柄
BT holder

SK 刀柄
SK holder

ISO 刀柄
ISO holder

刀柄配件
holder accessories

SF

SK-SF Shrink Fit Holder SK-SF燒結式熱裝刀柄 (一體式)



MAX
50,000
min⁻¹

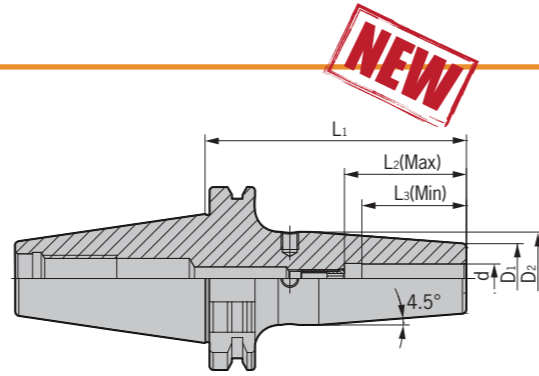

NEW

型號 Specification	d	D ₁	D ₂	L ₁	L ₂ (Max)	L ₃ (Min)	重量 Weight
SK30- SF3-80	3	10	10	80	-	9	0.35
SF4-80	4	10	10	80	-	12	0.40
SF5-80	5	10	10	80	-	15	0.43
SF6-80	6	21	27	80	28	18	0.45
SF8-80	8	21	27	80	34	24	0.50
SF10-80	10	24	32	80	40	30	0.55
SF12-80	12	24	32	80	40	30	0.62
SF14-80	14	27	34	80	42	32	0.65
SF16-80	16	27	34	80	42	32	0.68
SF18-80	18	33	42	80	50	40	0.71
SF20-90	20	33	42	90	50	40	0.75
SK40- SF3-90	3	10	10	90	-	9	1.00
SF4-90	4	10	10	90	-	12	1.10
SF5-90	5	10	10	90	-	15	1.00
SF6-90	6	21	27	90	28	18	1.15
SF6-130	6	21	27	130	28	18	1.20
SF6-160	6	21	27	160	28	18	1.40
SF6-200	6	21	27	200	28	18	1.90
SF8-90	8	21	27	90	34	24	1.15
SF8-130	8	21	27	130	34	24	1.30
SF8-160	8	21	27	160	34	24	1.50
SF8-200	8	21	27	200	34	24	1.90
SF10-90	10	24	32	90	40	30	1.20
SF10-130	10	24	32	130	40	30	1.50
SF10-160	10	24	32	160	40	30	1.80
SF10-200	10	24	32	200	40	30	1.90
SF12-90	12	24	32	90	40	30	1.30
SF12-130	12	24	32	130	40	30	1.60
SF12-160	12	24	32	160	40	30	1.80
SF12-200	12	24	32	200	40	30	2.00
SF14-90	14	27	34	90	42	32	1.30
SF14-130	14	27	34	130	42	32	1.60
SF14-160	14	27	34	160	42	32	1.80
SF14-200	14	27	34	200	42	32	2.00
SF16-90	16	27	34	90	42	32	1.40
SF16-130	16	27	34	130	42	32	1.70
SF16-160	16	27	34	160	42	32	1.95
SF16-200	16	27	34	200	42	32	2.20

轉下頁
See next page

SF

SK-SF Shrink Fit Holder SK-SF燒結式熱裝刀柄 (一體式)

型號 Specification	d	D ₁	D ₂	L ₁	L ₂ (Max)	L ₃ (Min)	重量 Weight
SK40- SF18-90	18	33	42	90	50	40	1.50
SF18-130	18	33	42	130	50	40	1.80
SF18-160	18	33	42	160	50	40	2.00
SF18-200	18	33	42	200	50	40	2.30
SF20-90	20	33	42	90	50	40	1.55
SF20-130	20	33	42	130	50	40	1.85
SF20-160	20	33	42	160	50	40	2.05
SF20-200	20	33	42	200	50	40	2.35
SF25-100	25	44	53	100	55	45	1.65
SF25-130	25	44	53	130	55	45	1.90
SF25-160	25	44	53	160	55	45	2.20
SF25-200	25	44	53	200	55	45	2.50
SF32-100	32	44	53	100	60	50	2.00
SF32-130	32	44	53	130	60	50	2.30
SF32-160	32	44	53	160	60	50	2.60
SK50- SF6-100	6	21	27	100	28	18	3.70
SF6-130	6	21	27	130	28	18	3.80
SF6-160	6	21	27	160	28	18	3.88
SF6-200	6	21	27	200	28	18	4.00
SF8-100	8	21	27	100	34	24	3.60
SF8-130	8	21	27	130	34	24	3.70
SF8-160	8	21	27	160	34	24	3.90
SF8-200	8	21	27	200	34	24	4.00
SF10-100	10	24	32	100	40	30	3.65
SF10-130	10	24	32	130	40	30	3.78
SF10-160	10	24	32	160	40	30	4.00
SF10-200	10	24	32	200	40	30	4.15
SF12-100	12	24	32	100	40	30	3.70
SF12-130	12	24	32	130	40	30	3.80
SF12-160	12	24	32	160	40	30	4.10
SF12-200	12	24	32	200	40	30	4.25
SF14-100	14	27	34	100	42	32	3.70
SF14-130	14	27	34	130	42	32	3.80
SF14-160	14	27	34	160	42	32	4.10
SF14-200	14	27	34	200	42	32	4.25
SF16-100	16	27	34	100	42	32	3.75
SF16-130	16	27	34	130	42	32	3.88
SF16-160	16	27	34	160	42	32	4.20
SF16-200	16	27	34	200	42	32	4.50
SF18-100	18	33	42	100	50	40	3.75
SF18-130	18	33	42	130	50	40	3.88
SF18-160	18	33	42	160	50	40	4.20
SF18-200	18	33	42	200	50	40	4.50

轉下頁
See next page

SF/DSF

SK-SF Shrink Fit Holder
SK-SF燒結式熱裝刀柄（一體式）



MAX
50,000
min⁻¹

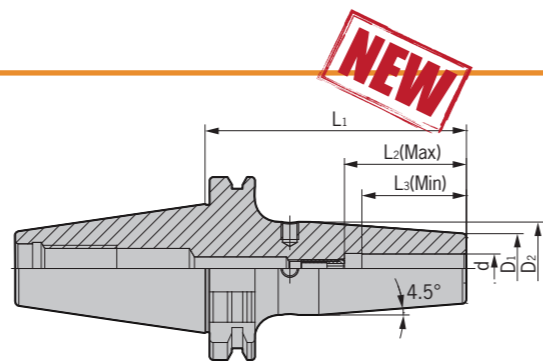

型號 Specification	d	D ₁	D ₂	L ₁	L ₂ (Max)	L ₃ (Min)	重量 Weight
SK50- SF20-100	20	33	42	100	50	40	3.80
SF20-130	20	33	42	130	50	40	4.00
SF20-160	20	33	42	160	50	40	4.30
SF20-200	20	33	42	200	50	40	4.60
SF25-100	25	44	53	100	55	45	3.82
SF25-130	25	44	53	130	55	45	4.05
SF25-160	25	44	53	160	55	45	4.33
SF25-200	25	44	53	200	55	45	4.65
SF32-100	32	44	53	100	60	50	4.00
SF32-130	32	44	53	130	60	50	4.40
SF32-160	32	44	53	160	60	50	4.70
SF32-200	32	44	53	200	60	50	5.00

特點 / Feature

- 動平衡設定: G2.5; 25,000 rpm。 ■Balanced: G2.5; 25,000 rpm;
- 3D處徑向跳動0.003 mm。 ■Runout (X3D): < 0.003 mm.

SK-DSF Shrink Fit Holder
SK-DSF燒結式熱裝刀柄（分體式）



MAX
50,000
min⁻¹

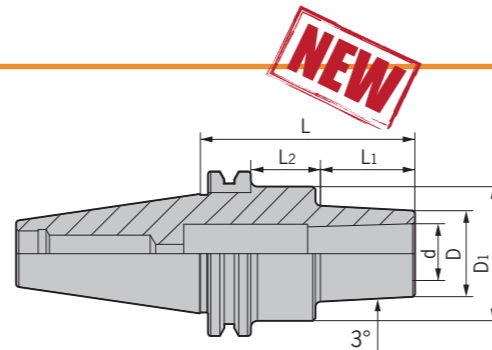
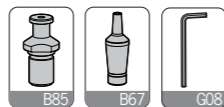

型號 Specification	D	D ₁	d	L ₁	L ₂	L	L型扳手 Wrench	重量 Weight
SK40- DSF12-45	38	-	12	18	-	50	L06	1.10
DSF12-75	38	-	12	48	-	75	L06	1.40
DSF12-135	41	-	12	108	-	135	L06	2.20
SK50- DSF12-75	38	65	12	25	21	75	L06	4.00
DSF12-105	41	65	12	55	21	105	L06	4.40
DSF12-135	41	65	12	85	21	135	L06	4.70

注：報價時含扳手。
Notice: Wrench is included.

特點 / Feature

- 動平衡設定: G2.5; 25,000 rpm。 ■Balanced: G2.5; 25,000 rpm;
- 3D處徑向跳動0.003 mm。 ■Runout (X3D): < 0.003 mm.

DC

SK-DC Precision Slim Collet Chuck
SK-DC小徑精密夾頭本體



MAX
50,000
min⁻¹

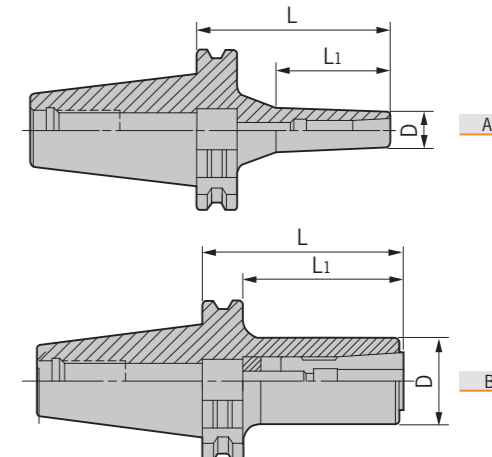
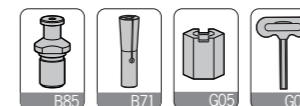

型號 Specification	圖示 Figure	D	L ₁	L	適用筒夾 Suit collet	拉緊螺釘 Tension screw	止動螺母 Stop nut	扳手 Wrench	重量 Weight
SK40- DC6-90	A	13	45	90	DC6	E050U450	ZD6-2	T04-L	1.05
DC8-90	A	22	53	90	DC8	E060U600	ZD8-1	T05-L	1.10
DC10-90	B	28	74	90	DC10	E080U300	ZD10-2	T06-L	1.20
DC12-90	B	34	74	90	DC12	E100U350	ZD12-1	T08-L	1.28
SK50- DC10-110	A	28	57	110	DC10	E080U800	ZD12-1	T06-L	4.20
DC12-110	B	34	94	110	DC12	E100U350	ZD12-1	T08-L	4.70

注：報價時含扳手，筒夾需單獨訂購。
Notice: Wrench is included, while collet shall be ordered separately.

特點 / Feature

- 動平衡設定: G2.5; 30,000 rpm。 ■Balanced: G2.5; 30,000 rpm;
- 3D處徑向跳動0.003 mm。 ■Runout (X3D): < 0.003 mm.



MAX
45,000
min⁻¹

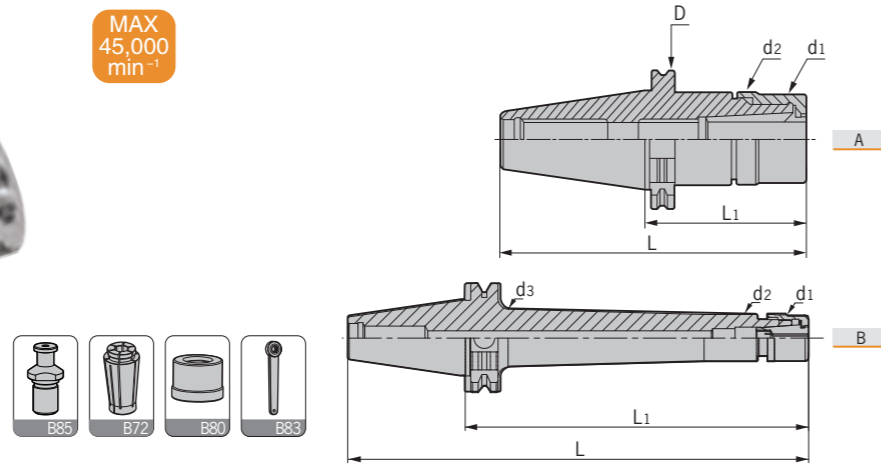

型號 Specification	圖示 Figure	D	d ₁	d ₂	d ₃	L	L ₁	T	適用筒夾 Suit collet	重量 Weight
SK30- GSK6-70	A	50	19.5	20	-	117.8	70	M6x1	DSK6	0.45
GSK6-100	A	50	19.5	20	-	147.8	100	M6x1	DSK6	0.64
GSK10-70	A	50	27	27.5	-	117.8	70	M10x1.5	DSK10	0.46
GSK10-100	A	50	27	27.5	-	147.8	100	M10x1.5	DSK10	0.70
GSK16-100	A	50	40	40.5	-	147.8	100	M16x2	DSK16	1.00
GSK16-120	A	50	40	40.5	-	167.8	120	M16x2	DSK16	1.25
GSK16-150	A	50	40	40.5	-	197.8	150	M16x2	DSK16	1.35
GSK20-70	A	50	48	48.5	-	117.8	70	M16x2	DSK20	0.75
GSK20-100	A	50	48	48.5	-	147.8	100	M16x2	DSK20	1.15
GSK25-100	A	50	55	55	-	147.8	100	M20x2	DSK25	1.20
SK40- GSK6-70	A	63.55	19.5	20	-	138.4	70	M6x1	DSK6	1.05
GSK6-100	A	63.55	19.5	20	-	168.4	100	M6x1	DSK6	1.25
GSK6-120	A	63.55	19.5	20	-	188.4	120	M6x1	DSK6	1.39
GSK6-150L	B	63.55	19.5	20	26.4	218.4	150	M6x1	DSK6	1.55
GSK10-70	A	63.55	27	27.5	-	138.4	70	M10x1.5	DSK10	1.10
GSK10-100	A	63.55	27	27.5	-	168.4	100	M10x1.5	DSK10	1.30
GSK10-120	A	63.55	27	27.5	-	188.4	120	M10x1.5	DSK10	1.42
GSK10-150	A	63.55	27	27.5	-	218.4	150	M10x1.5	DSK10	1.55
GSK10-200L	B	63.55	27	27.5	33.7	268.4	200	M10x1.5	DSK10	1.85
GSK16-70	A	63.55	40	40.5	-	138.4	70	M16x2	DSK16	1.21
GSK16-100	A	63.55	40	40.5	-	168.4	100	M16x2	DSK16	1.42
GSK16-120	A	63.55	40	40.5	-	188.4	120	M16x2	DSK16	1.61
GSK16-150	A	63.55	40	40.5	-	218.4	150	M16x2	DSK16	1.80
GSK16-200L	B	63.55	40	40.5	45.7	268.4	200	M16x2	DSK16	1.95
GSK20-70	A	63.55	48	48.5	-	138.4	70	M16x2	DSK20	1.52
GSK20-100	A	63.55	48	48.5	-	168.4	100	M16x2	DSK20	1.68
GSK20-120	A	63.55	48	48.5	-	188.4	120	M16x2	DSK20	1.90
GSK20-150	A	63.55	48	48.5	-	218.4	150	M16x2	DSK20	2.10
GSK20-200L	B	63.55	48	48.5	55.7	268.4	200	M16x2	DSK20	2.30
GSK25-100	A	63.55	55	55	-	168.4	100	M20x2	DSK25	1.81
GSK25-120	A	63.55	55	55	-	188.4	120	M20x2	DSK25	2.05
GSK25-150	A	63.55	55	55	-	218.4	150	M20x2	DSK25	2.30
GSK25-200L	B	63.55	55	55	59.9	268.4	200	M20x2	DSK25	2.65

轉下頁
See next page

型號 Specification	圖示 Figure	D	d ₁	d ₂	d ₃	L	L ₁	T	適用筒夾 Suit collet	重量 Weight
SK50- GSK10-105	A	97.5	27	27.5	-	206.75	105	M10x1.5	DSK10	3.78
GSK10-135	A	97.5	27	27.5	-	236.75	135	M10x1.5	DSK10	4.00
GSK10-165	A	97.5	27	27.5	-	266.75	165	M10x1.5	DSK10	4.33
GSK10-200L	B	97.5	27	27.5	35.2	301.75	200	M10x1.5	DSK10	4.75
GSK16-100	A	97.5	40	40.5	-	201.75	100	M16x2	DSK16	3.93
GSK16-125	A	97.5	40	40.5	-	226.75	125	M16x2	DSK16	4.17
GSK16-150	A	97.5	40	40.5	-	251.75	150	M16x2	DSK16	4.49
GSK16-200L	B	97.5	40	40.5	48.4	301.75	200	M16x2	DSK16	5.50
GSK16-250L	B	97.5	40	40.5	48.4	351.75	250	M16x2	DSK16	6.50
GSK20-100	A	97.5	48	48.5	-	201.75	100	M16x2	DSK20	4.10
GSK20-125	A	97.5	48	48.5	-	226.75	125	M16x2	DSK20	4.32
GSK20-150	A	97.5	48	48.5	-	251.75	150	M16x2	DSK20	4.65
GSK20-200	A	97.5	48	48.5	-	301.75	200	M16x2	DSK20	5.75
GSK20-250L	B	97.5	48	48.5	55.4	351.75	250	M16x2	DSK20	6.78
GSK20-300L	B	97.5	48	48.5	55.4	401.75	300	M16x2	DSK20	7.80
GSK25-100	A	97.5	55	55	-	201.75	100	M20x2	DSK25	4.10
GSK25-125	A	97.5	55	55	-	226.75	125	M20x2	DSK25	4.62
GSK25-150	A	97.5	55	55	-	251.75	150	M20x2	DSK25	5.10
GSK25-200	A	97.5	55	55	-	301.75	200	M20x2	DSK25	5.81
GSK25-250L	B	97.5	55	55	61.4	351.75	250	M20x2	DSK25	6.85
GSK25-300L	B	97.5	55	55	61.4	401.75	300	M20x2	DSK25	8.00

注：筒夾與扳手需單獨另購，可選配中心出水螺帽與端面出水螺帽詳見B73頁。
Notice: Collets and wrenches shall be ordered separately.

特點 / Feature

- 動平衡設定: G2.5; 25,000 rpm。
- 3D處徑向跳動0.005 mm。

- Balanced: G2.5; 25,000 rpm;
- Runout (X3D): < 0.005 mm.

DSK

SK-DSK High Speed Milling Holder
SK-DSK高速精密筒夾本體

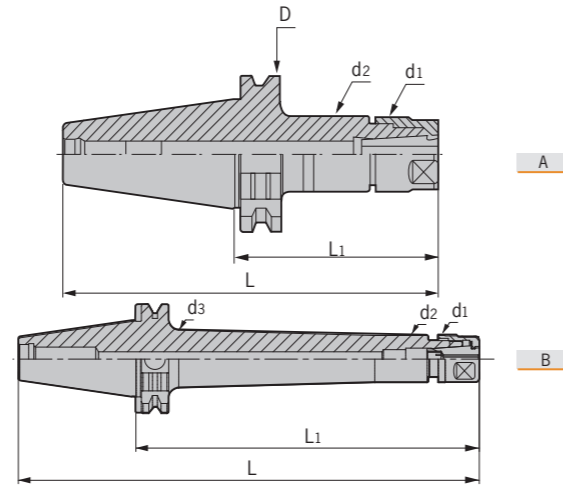
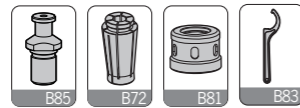

型號 Specification	圖示 Figure	D	d ₁	d ₂	d ₃	L	L ₁	T	適用筒夾 Suit collet	重量 Weight
SK30- DSK6-70	A	50	20	20	-	117.8	70	M6x1	DSK6	0.45
DSK6-100	A	50	20	20	-	147.8	100	M6x1	DSK6	0.64
DSK10-70	A	50	27.5	27.5	-	117.8	70	M10x1.5	DSK10	0.46
DSK10-100	A	50	27.5	27.5	-	147.8	100	M10x1.5	DSK10	0.70
DSK16-100	A	50	40.5	40.5	-	147.8	100	M16x2	DSK16	1.00
DSK16-120	A	50	40.5	40.5	-	167.8	120	M16x2	DSK16	1.25
DSK16-150	A	50	40.5	40.5	-	197.8	150	M16x2	DSK16	1.35
DSK20-70	A	50	48.5	48.5	-	117.8	70	M16x2	DSK20	0.75
DSK20-100	A	50	48.5	48.5	-	147.8	100	M16x2	DSK20	1.15
DSK25-100	A	50	55	55	-	147.8	100	M20x2	DSK25	1.20
SK40- DSK6-70	A	63.55	20	20	-	138.4	70	M6x1	DSK6	1.05
DSK6-100	A	63.55	20	20	-	168.4	100	M6x1	DSK6	1.25
DSK6-120	A	63.55	20	20	-	188.4	120	M6x1	DSK6	1.39
DSK6-150L	B	63.55	20	20	26.4	218.4	150	M6x1	DSK6	1.55
DSK10-70	A	63.55	27.5	27.5	-	138.4	70	M10x1.5	DSK10	1.10
DSK10-100	A	63.55	27.5	27.5	-	168.4	100	M10x1.5	DSK10	1.30
DSK10-120	A	63.55	27.5	27.5	-	188.4	120	M10x1.5	DSK10	1.42
DSK10-150	A	63.55	27.5	27.5	-	218.4	150	M10x1.5	DSK10	1.55
DSK10-200L	B	63.55	27.5	27.5	33.7	268.4	200	M10x1.5	DSK10	1.85
DSK16-70	A	63.55	40.5	40.5	-	138.4	70	M16x2	DSK16	1.21
DSK16-100	A	63.55	40.5	40.5	-	168.4	100	M16x2	DSK16	1.42
DSK16-120	A	63.55	40.5	40.5	-	188.4	120	M16x2	DSK16	1.61
DSK16-150	A	63.55	40.5	40.5	-	218.4	150	M16x2	DSK16	1.80
DSK16-200L	B	63.55	40.5	40.5	45.7	268.4	200	M16x2	DSK16	1.95
DSK20-70	A	63.55	48.5	48.5	-	138.4	70	M16x2	DSK20	1.52
DSK20-100	A	63.55	48.5	48.5	-	168.4	100	M16x2	DSK20	1.68
DSK20-120	A	63.55	48.5	48.5	-	188.4	120	M16x2	DSK20	1.90
DSK20-150	A	63.55	48.5	48.5	-	218.4	150	M16x2	DSK20	2.10
DSK20-200L	B	63.55	48.5	48.5	55.7	268.4	200	M16x2	DSK20	2.30
DSK25-100	A	63.55	55	55	-	168.4	100	M20x2	DSK25	1.81
DSK25-120	A	63.55	55	55	-	188.4	120	M20x2	DSK25	2.05
DSK25-150	A	63.55	55	55	-	218.4	150	M20x2	DSK25	2.30
DSK25-200L	B	63.55	55	55	59.9	268.4	200	M20x2	DSK25	2.65

轉下頁
See next page

DSK

SK-DSK High Speed Milling Holder
SK-DSK高速精密筒夾本體

型號 Specification	圖示 Figure	D	d ₁	d ₂	d ₃	L	L ₁	T	適用筒夾 Suit collet	重量 Weight
SK50- DSK10-105	A	97.5	27.5	27.5	-	206.75	105	M10x1.5	DSK10	3.78
DSK10-135	A	97.5	27.5	27.5	-	236.75	135	M10x1.5	DSK10	4.00
DSK10-165	A	97.5	27.5	27.5	-	266.75	165	M10x1.5	DSK10	4.33
DSK10-200L	B	97.5	27.5	27.5	35.2	301.75	200	M10x1.5	DSK10	4.75
DSK16-100	A	97.5	40.5	40.5	-	201.75	100	M16x2	DSK16	3.93
DSK16-125	A	97.5	40.5	40.5	-	226.75	125	M16x2	DSK16	4.17
DSK16-150	A	97.5	40.5	40.5	-	251.75	150	M16x2	DSK16	4.49
DSK16-200L	B	97.5	40.5	40.5	48.4	301.75	200	M16x2	DSK16	5.50
DSK16-250L	B	97.5	40.5	40.5	48.4	351.75	250	M16x2	DSK16	6.50
DSK20-100	A	97.5	48.5	48.5	-	201.75	100	M16x2	DSK20	4.10
DSK20-125	A	97.5	48.5	48.5	-	226.75	125	M16x2	DSK20	4.32
DSK20-150	A	97.5	48.5	48.5	-	251.75	150	M16x2	DSK20	4.65
DSK20-200	A	97.5	48.5	48.5	-	301.75	200	M16x2	DSK20	5.75
DSK20-250L	B	97.5	48.5	48.5	55.4	351.75	250	M16x2	DSK20	6.78
DSK20-300L	B	97.5	48.5	48.5	55.4	401.75	300	M16x2	DSK20	7.80
DSK25-100	A	97.5	55	55	-	201.75	100	M20x2	DSK25	4.1
DSK25-125	A	97.5	55	55	-	226.75	125	M20x2	DSK25	4.62
DSK25-150	A	97.5	55	55	-	251.75	150	M20x2	DSK25	5.10
DSK25-200	A	97.5	55	55	-	301.75	200	M20x2	DSK25	5.81
DSK25-250L	B	97.5	55	55	61.4	351.75	250	M20x2	DSK25	6.85
DSK25-300L	B	97.5	55	55	61.4	401.75	300	M20x2	DSK25	8.00

注：筒夾與扳手需單獨另購，可選配中心出水螺帽與端面出水螺帽詳見B73頁。
Notice: Collets and wrenches shall be ordered separately.

特點 / Feature

- 動平衡設定: G2.5; 20,000 rpm.
- 3D處徑向跳動0.005 mm.

- Balanced: G2.5; 20,000 rpm;
- Runout (X3D): < 0.005 mm.

ER

SK-ER Spring Collet Chuck
SK-ER彈性筒夾本體

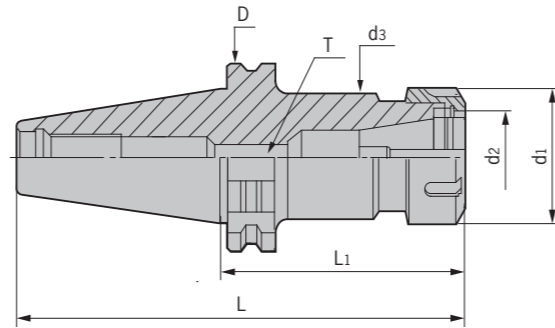
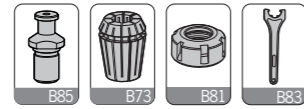

型號 Specification	D	d ₁	d ₂	d ₃	L ₁	L	重量 Weight
SK30- ER11-60	50	19	11	19	60	127.8	0.45
ER16-70	50	28	16	28	70	117.8	0.52
ER16-100	50	28	16	28	100	147.8	0.64
ER20-70	50	34	20	34	70	117.8	0.57
ER20-100	50	34	20	34	100	147.8	0.76
ER25-70	50	42	25	42	70	117.8	0.66
ER32-70	50	50	32	50	70	117.8	0.72
SK40- ER11-80	63.55	19	11	19	80	148.4	0.70
ER11-125	63.55	19	11	19	125	193.4	0.96
ER16-70	63.55	28	16	28	70	138.4	1.08
ER16-100	63.55	28	16	28	100	168.4	1.21
ER16-125	63.55	28	16	28	125	193.4	1.30
ER16-150	63.55	28	16	28	150	218.4	1.44
ER20-70	63.55	34	20	34	70	138.4	1.12
ER20-100	63.55	34	20	34	100	168.4	1.33
ER20-135	63.55	34	20	34	135	203.4	1.48
ER20-160	63.55	34	20	34	160	228.4	1.65
ER25-70	63.55	42	25	42	70	138.4	1.22
ER25-100	63.55	42	25	42	100	168.4	1.49
ER25-150	63.55	42	25	42	150	218.4	1.97
ER25-200	63.55	42	25	42	200	268.4	2.23
ER32-70	63.55	50	32	50	70	138.4	1.27
ER32-100	63.55	50	32	50	100	168.4	1.70
ER32-150	63.55	50	32	50	150	218.4	2.39
ER40-80	63.55	63	40	63	80	148.4	1.62
ER40-100	63.55	63	40	63	100	168.4	2.08
ER40-135	63.55	63	40	63	135	218.4	2.75
SK50- ER16-100	97.5	28	16	28	100	201.75	3.77
ER16-135	97.5	28	16	28	135	236.75	3.95
ER16-160	97.5	28	16	28	160	261.75	4.04
ER16-200	97.5	28	16	28	200	301.75	5.04
ER20-100	97.5	34	20	34	100	201.75	3.86
ER20-135	97.5	34	20	34	135	236.75	4.08
ER20-160	97.5	34	20	34	160	261.75	4.22

轉下頁
See next page

ER/VER

SK-ER Spring Collet Chuck
SK-ER彈性筒夾本體

型號 Specification	D	d ₁	d ₂	d ₃	L ₁	L	重量 Weight
SK50- ER25-70	97.5	42	25	42	70	171.75	3.64
ER25-100	97.5	42	25	42	100	201.75	4.26
ER25-150	97.5	42	25	42	150	251.75	4.54
ER25-200	97.5	42	25	42	200	301.75	5.01
ER32-80	97.5	50	32	50	80	181.75	3.80
ER32-120	97.5	50	32	50	120	221.75	4.35
ER32-160	97.5	50	32	50	160	261.75	4.82
ER32-200	97.5	50	32	50	200	301.75	5.32
ER40-80	97.5	63	40	63	80	181.75	3.93
ER40-120	97.5	63	40	63	120	221.75	4.86
ER40-160	97.5	63	40	63	160	261.75	5.51
ER40-200	97.5	63	40	63	200	301.75	6.21

注：筒夾和扳手需單獨訂購。
Notice: Collets and wrenches shall be ordered separately.

SK-VER Tapping Chuck
SK-VER快換式微補償攻牙刀柄

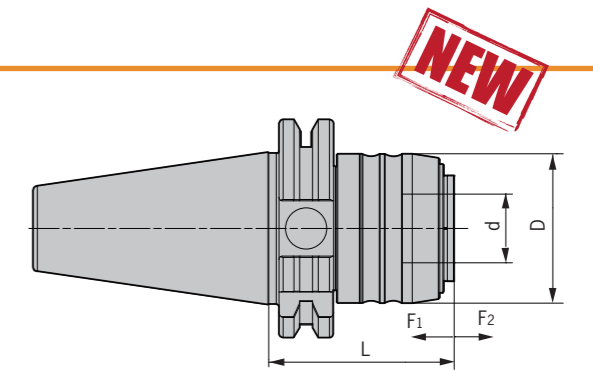
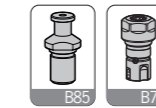

型號 Specification	D	d	L	F ₁	F ₂	攻牙能力 Tapping capacity	適用延長杆 Suit extender	重量 Weight
SK40- VER16-53	43.5	20	53	0.2	1	M3-M12	VER16-M24	1.05
VER20-80	52	25	80	0.2	1	M5-M16	VER20-M26	1.22
VER25-90	60	32	90	0.2	1	M6-M20	VER25-M28	1.42
VER32-106	72	40	106	0.2	1	M10-M24	VER32-M30	1.71
VER40-115	87	50	115	0.2	1	M14-M33	VER40-M32	2.15
SK50- VER16-53	43.5	20	53	0.2	1	M3-M12	VER16-M24	3.36
VER20-83	52	25	83	0.2	1	M5-M16	VER20-M26	3.55
VER25-74	60	32	74	0.2	1	M6-M20	VER25-M28	3.65
VER32-100	72	40	100	0.2	1	M10-M24	VER32-M30	4.15
VER40-115	87	50	115	0.2	1	M14-M33	VER40-M32	4.35

注：筒夾和扳手需單獨訂購。
Notice: Collets and wrenches shall be ordered separately.

特點 / Feature

- 顯著提高絲錐使用壽命80%以上。
- 有效提高加工生產效率2-4倍。
- 明顯提高表面加工質量與精度。
- 選用ER攻絲專用筒夾夾持。
- 無需依賴設備精度。
- 擠壓絲錐首選。
- Tap tool life increased by 80% and above;
- Work efficiency increased 2 to 4 times;
- Better surface quality;
- With ER tapping collet;
- Best choice for squeeze taps.

TER

SK-TER Tapping Chuck
SK-TER伸縮攻牙器刀柄

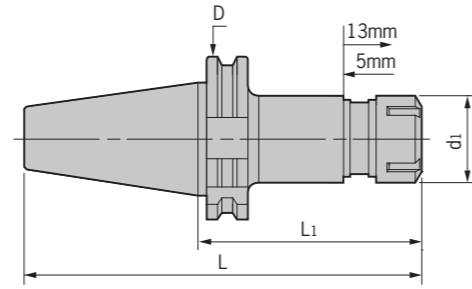
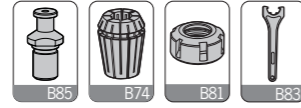

型號 Specification	D	d1	L1	L	適用筒夾 Suit collet	攻牙能力 Tapping capacity	重量 Weight
SK40- TER16-120	63.55	28	120	188.4	ER16	M3-M10	1.10
TER16-150	63.55	28	150	218.4	ER16	M3-M10	1.40
TER20-100	63.55	34	100	168.4	ER20	M3-M16	1.22
TER20-150	63.55	34	150	218.4	ER20	M3-M16	1.70
TER20-200	63.55	28	200	268.4	ER20	M3-M16	2.20
TER32-120	63.55	50	120	188.4	ER32	M3-M27	1.52
SK50- TER16-120	97.50	28	120	221.75	ER16	M3-M10	3.80
TER16-150	97.50	28	150	251.75	ER16	M3-M10	4.12
TER20-100	97.50	34	100	201.75	ER20	M3-M16	3.83
TER20-150	97.50	34	150	251.75	ER20	M3-M16	4.45
TER20-200	97.50	28	200	301.75	ER20	M3-M16	5.00
TER32-120	97.50	50	120	221.75	ER32	M3-M27	4.40

注：筒夾和扳手需單獨訂購。
Notice: Collets and wrenches shall be ordered separately.

特點 / Feature

- 攻牙器使用ER筒夾夾持，請您在選購時認準 ER筒夾內徑。
- 本刀體的攻牙器頭部採用了浮動設計，攻螺紋時的扭矩可通過內部鋼珠傳遞。
- 本刀柄主要用于中心機和CNC銑床攻牙。
- Clamped with ER spring collect, please check the innsize of ER collet When you choose .
- The tapping head of this holder designed with floating tap, the tapping torque is transmitted through the ball inside the floating tap holder.
- Mainly used on machine center and CNC milling machine for tapping.

TPG/TPM

SK-TPG Rigid Tapping Chuck
SK-TPG剛性攻牙刀柄

NEW

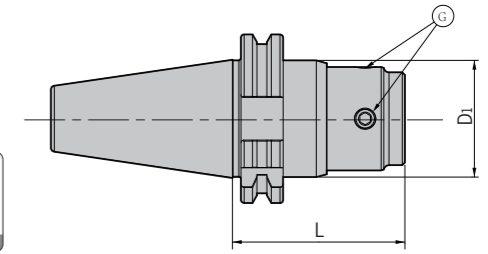
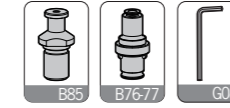

型號 Specification	D1	L	G	適用筒夾 Suit collet	L型扳手 Wrench	攻牙能力 Tapping capacity	重量 Weight
SK40- TPG312	44	65	M8X1P	TPE312	L06	M3-M12	1.23
TPG1024	56	75	M10X1P	TPE1024	L08	M10-M24	1.39
SK50- TPG312	44	80	M8X1P	TPE312	L06	M3-M12	3.88
TPG1024	56	80	M10X1P	TPE1024	L08	M10-M24	4.09

注：筒夾需單獨訂購。
Notice: Collets shall be ordered separately.

特點 / Feature

- 適用於高精度同步數控加工。
- 由主軸中心提供內冷卻。
- 為達到高速攻絲的剛性設計。
- 短型且緊湊的設計。
- For high precision tapping;
- With internal coolant hole;
- Design for high speed and rigid tapping;
- Short and compact design.

SK-TPM Tapping Chuck With High Rigidity
SK-TPM扭力伸縮攻牙刀柄

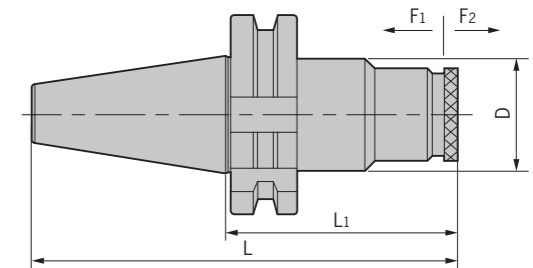
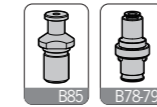

型號 Specification	D	F1	F2	L1	L	適用筒夾 Suit collet	攻牙能力 Tapping capacity	重量 Weight
SK40- TPM316	50	10	20	96	163	TPD316	M3-M16	1.56
TPM830	66	10	25	143.6	230	TPD830	M8-M30	2.62
SK50- TPM316	50	10	20	96	163	TPD316	M3-M16	4.24
TPM830	66	10	25(80)	143.6	230	TPD830	M8-M30	4.77

注：筒夾需單獨訂購。
Notice: Collets shall be ordered separately.

HPM/HPC

SK-HPM High Speed Milling Chuck
SK-HPM高速精密強力銑刀夾頭



MAX
30,000
min⁻¹

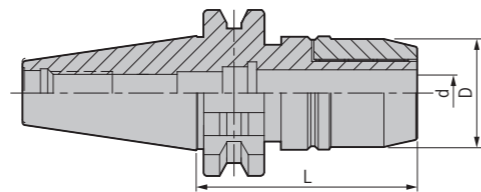
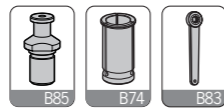

型號 Specification	範圍 Range	D	d	L	適用筒夾 Suit collet	重量 Weight
SK30- HPM20-75	6-20	54	20	75	SC20	1.80
SK40- HPM20-80	6-20	54	20	80	SC20	2.40
HPM20-105	6-20	54	20	105	SC20	2.50
HPM20-135	6-20	54	20	135	SC20	2.80
HPM32-105	6-32	68	32	105	SC32	2.80
HPM32-135	6-32	68	32	135	SC32	3.00
SK50- HPM20-105	6-20	54	20	105	SC20	4.50
HPM20-135	6-20	54	20	135	SC20	4.70
HPM32-110	6-32	68	32	110	SC32	5.20
HPM32-135	6-32	68	32	135	SC32	5.90

SK-HPC High Speed Milling Chuck
SK-HPC高速精密強力銑刀夾頭



MAX
30,000
min⁻¹

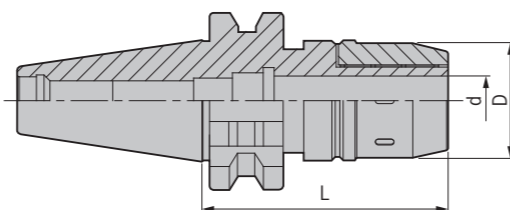
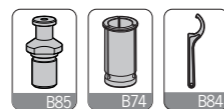

型號 Specification	範圍 Range	D	d	L	適用筒夾 Suit collet	重量 Weight
SK30- HPC16-70	3-16	46	16	70	SC16	1.40
HPC20-75	6-20	51.5	20	75	SC20	1.80
SK40- HPC16-70	3-16	46	16	70	SC16	1.60
HPC16-105	3-16	46	16	105	SC16	1.80
HPC16-135	3-16	46	16	135	SC16	2.30
HPC20-80	6-20	51.5	20	80	SC20	2.40
HPC20-105	6-20	51.5	20	105	SC20	2.50
HPC20-135	6-20	51.5	20	135	SC20	2.80
HPC32-105	6-32	70.5	32	105	SC32	2.80
HPC32-135	6-32	70.5	32	135	SC32	3.00
SK50- HPC16-90	3-16	46	16	90	SC16	3.90
HPC16-110	3-16	46	16	110	SC16	4.10
HPC16-135	3-16	46	16	135	SC16	4.30
HPC16-150	3-16	46	16	150	SC16	4.50
HPC20-105	6-20	51.5	20	105	SC20	4.50
HPC20-135	6-20	51.5	20	135	SC20	4.70
HPC20-150	6-20	51.5	20	150	SC20	4.90
HPC32-110	6-32	70.5	32	110	SC32	5.20
HPC32-135	6-32	70.5	32	135	SC32	5.90
HPC32-165	6-32	70.5	32	165	SC32	6.60

注：報價時含扳手，筒夾需單獨訂購。
Notice: Wrench is included, while collet shall be ordered separately.

特點 / Feature

- 動平衡設定: G6.3; 15,000 rpm。
- 3D處徑向跳動0.02 mm。

- Balanced: G6.3; 15,000 rpm;
- Runout (X3D): < 0.02 mm.



MLC

SK-MLC Power Milling Chuck
SK-MLC強力筒夾本體

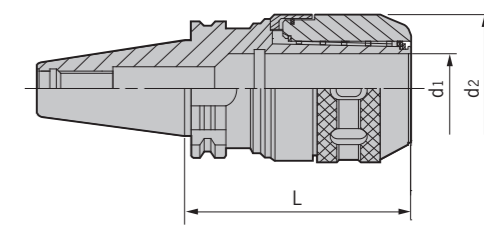
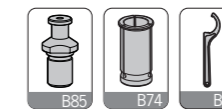

型號 Specification	範圍 Range	D	d	L	適用筒夾 Suit collet	重量 Weight
SK30- MLC20-85	6-20	51.5	20	85	SC20	1.90
MLC20-100	6-20	51.5	20	100	SC20	2.10
MLC32-135	6-32	70.5	32	135	SC32	3.00
SK40- MLC20-85	6-20	51.5	20	85	SC20	2.40
MLC20-100	6-20	51.5	20	100	SC20	2.50
MLC20-135	6-20	51.5	20	135	SC20	2.80
MLC32-105	6-32	70.5	32	105	SC32	2.80
MLC32-135	6-32	70.5	32	135	SC32	3.10
SK50- MLC20-105	6-20	51.5	20	105	SC20	4.50
MLC20-150	6-20	51.5	20	150	SC20	4.90
MLC32-85	6-32	70.5	32	85	SC32	4.50
MLC32-110	6-32	70.5	32	110	SC32	5.20
MLC32-135	6-32	70.5	32	135	SC32	5.90
MLC42-110	6-42	86.0	42	110	SC42	6.00
MLC42-165	6-42	86.0	42	165	SC42	7.40

注：報價時含扳手，筒夾需單獨訂購。
Notice: Wrench is included, while collet shall be ordered separately.

特點 / Feature

- 刀柄採用四組220根針狀滾針經特殊排列而成。
- 端面鎖緊增強了本體鋼性強度。
- 立銑刀無振動無滑移實現了最大能力範圍的重銑削加工，跳動精度0.02mm。
- The tool holder uses four special layers with 220 pieces bearing arranged in particular.
- It can reduce the locking resistance and also show best performance on heavy cutting.
- The usual length of power milling chuck show that the highest runout accuracy can reach to 0.02mm.

SK-MLC Power Chuck Kit
SK-MLC強力筒夾本體套裝組

型號 Specification	筒夾 Collet	數量 PCS/SET	重量 Weight
SK40- MLC20-100-5PCS	SC20-6,8,10,12,16	5	7.30
MLC32-105-7PCS	SC32-6,8,10,12,16,20,25	7	7.80
SK50- MLC20-105-5PCS	SC20-6,8,10,12,16	5	7.50
MLC32-110-7PCS	SC32-6,8,10,12,16,20,25	7	8.40
MLC42-110-8PCS	SC42-6,8,10,12,16,20,25,32	8	11.40



SLN

SK-SLN Side Lock Holder
SK-SLN側固式刀柄

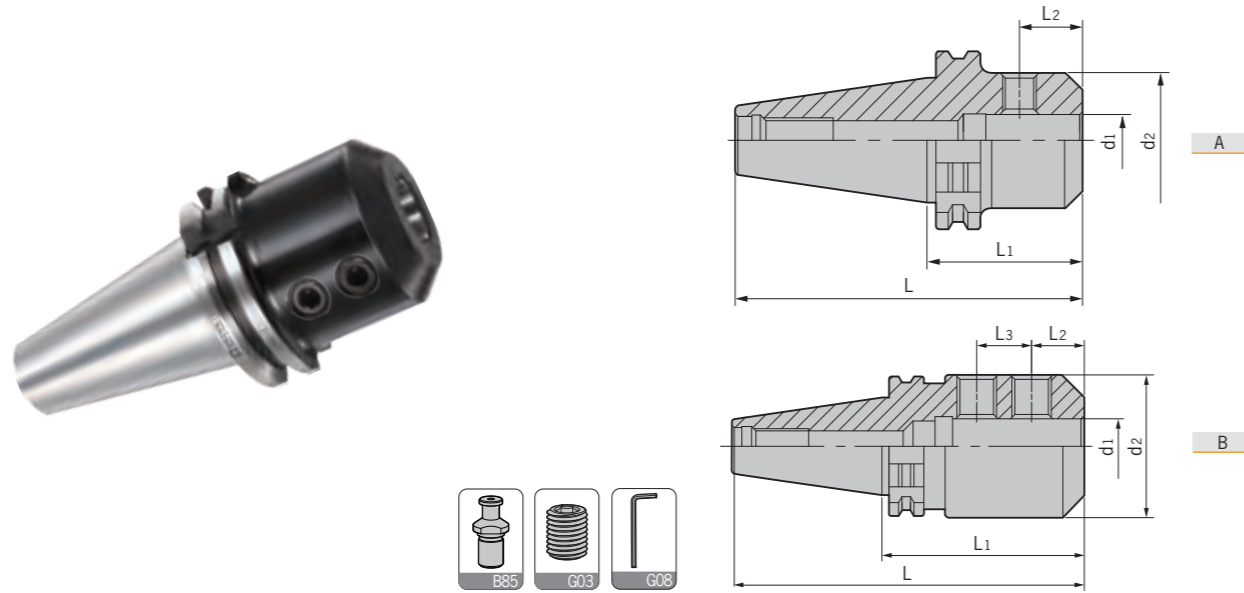

型號 Specification	圖示 Figure	d1	d2	L1	L2	L3	L	側面壓緊螺釘 Side-lock screw	重量 Weight	
SK30-	SLN6-50	A	6	25	50	18	-	97.8	M060U080	0.41
	SLN8-50	A	8	28	50	18	-	97.8	M080U100	0.46
	SLN10-50	A	10	35	50	20	-	97.8	M100U120	0.54
	SLN12-50	A	12	42	50	22.5	-	97.8	M120U140	0.61
	SLN16-63	A	16	48	63	24	-	110.8	M140U160	0.85
SK40-	SLN6-50	A	6	25	50	18	-	118.4	M060U080	1.00
	SLN8-50	A	8	28	50	18	-	118.4	M080U100	1.01
	SLN10-50	A	10	35	50	20	-	118.4	M100U100	1.15
	SLN12-50	A	12	42	50	22.5	-	118.4	M120U140	1.26
	SLN16-63	A	16	48	63	24	-	131.4	M140U160	1.31
	SLN20-63	A	20	52	63	25	-	131.4	M160U160	1.33
	SLN25-100	B	25	65	100	24	25	168.4	M180Z180P	2.32
SK50-	SLN32-105	B	32	72	105	24	28	168.4	M200Z180P	2.37
	SLN6-63	A	6	25	63	18	-	164.75	M060U080	3.12
	SLN8-63	A	8	28	63	18	-	164.75	M080U100	3.15
	SLN10-63	A	10	35	63	20	-	164.75	M100U100	3.63
	SLN12-63	A	12	42	63	22.5	-	164.75	M120U140	3.86
	SLN16-63	A	16	48	63	24	-	164.75	M140U160	3.90
	SLN20-63	A	20	52	63	25	-	164.75	M160U160	3.93
	SLN25-80	B	25	65	80	24	25	181.75	M180Z180P	4.62
	SLN32-100	B	32	72	100	24	25	201.75	M200Z180P	4.80
	SLN40-105	B	40	90	105	30	32	201.75	M200Z180P	5.21
SLN42-100	B	42	90	100	30	32	201.75	M200Z180P	6.00	

注：扳手需單獨訂購。
Notice: Wrenches shall be ordered separately.

MTA/MTB

SK-MTA Morse Taper Holder
SK-MTA莫氏錐套刀柄 (鑽頭套筒)

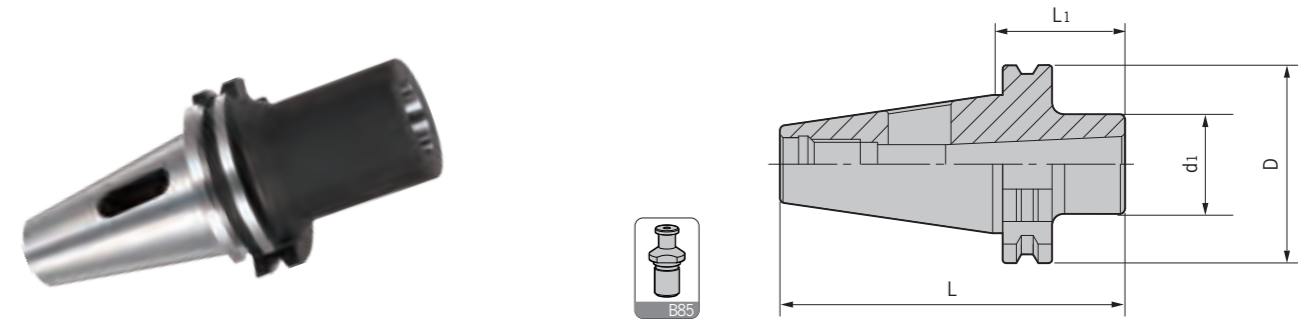

型號 Specification	莫氏錐度 MT.NO	D	d1	L1	L	重量 Weight
SK30-	MTA1-50	1	50	25	50	97.8
	MTA2-50	2	50	32	50	97.8
	MTA3-80	3	50	40	80	127.8
SK40-	MTA1-50	1	63.55	25	50	118.4
	MTA2-50	2	63.55	32	50	118.4
	MTA3-70	3	63.55	40	70	138.4
	MTA4-95	4	63.55	48	95	163.4
SK50-	MTA1-45	1	97.50	25	45	146.75
	MTA2-60	2	97.50	32	60	161.75
	MTA3-65	3	97.50	40	65	166.75
	MTA4-95	4	97.50	48	95	196.75
	MTA5-105	5	97.50	63	105	206.75

SK-MTB Morse Taper Holder
SK-MTB莫氏錐套刀柄 (螺絲鎖緊)

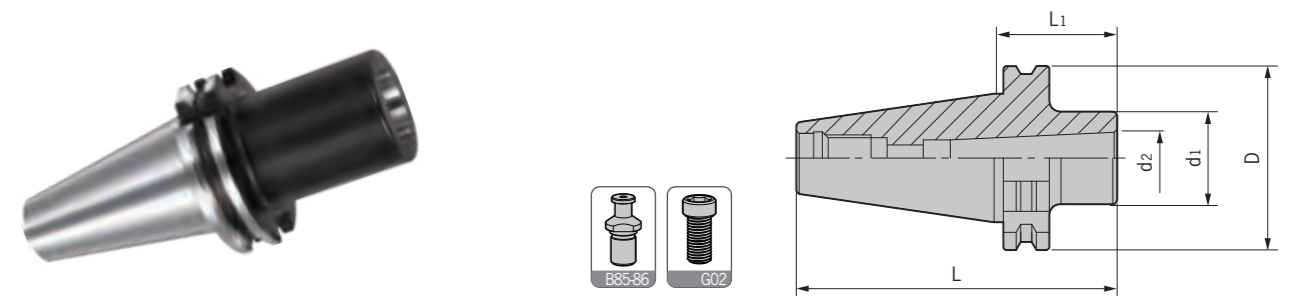

型號 Specification	莫氏錐度 MT.NO	D	d1	d2	L1	L	拉緊螺釘 Tension screw	範圍 Range	重量 Weight
SK30-	MTB1-50	1	50	25	12.065	50	E060U160	Φ10-Φ14	0.50
	MTB2-60	2	50	32	17.780	60	SK30-45-MT2	Φ16-Φ22	0.55
	MTB3-75	3	50	40	23.825	75	SK30-45-MT3	Φ24-Φ32	0.65
SK40-	MTB1-50	1	63.55	25	12.065	50	E060U160	Φ10-Φ14	0.95
	MTB2-50	2	63.55	32	17.780	50	E100U300-MTB	Φ16-Φ22	1.00
	MTB3-70	3	63.55	40	23.825	70	SK40-45-MT3	Φ24-Φ32	1.13
	MTB4-95	4	63.55	48	31.267	95	SK40-45-MT4	Φ32-Φ50	1.35
SK50-	MTB1-45	1	97.50	25	12.065	45	E060U250	Φ10-Φ14	3.59
	MTB2-60	2	97.50	32	17.780	60	E100U350	Φ16-Φ22	3.64
	MTB3-65	3	97.50	40	23.825	65	E120U400	Φ24-Φ32	3.60
	MTB4-95	4	97.50	48	31.267	95	E160U400-MTB	Φ32-Φ50	3.88
	MTB5-105	5	97.50	63	44.399	105	SK50-45-MT5	Φ55-Φ60	3.74

注：報價時含鎖緊拉釘。
Notice: Tension screw is included.

SPU/FMB

SK-SPU Drill Chuck Holder
SK-SPU直結式鑽夾頭刀柄

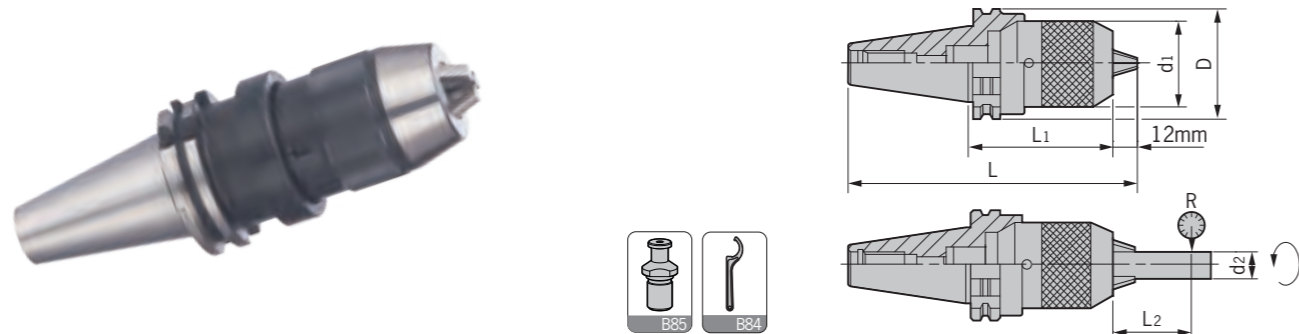

型號 Specification	D	d ₁	d ₂	L ₁	L ₂	L	偏擺精度 R	重量 Weight
SK30- SPU8-80	50	37	8	80	55	136.8	0.04	0.72
SPU13-120	50	50	13	120	75	179.8	0.04	1.70
SK40- SPU8-75	63.55	37	8	75	55	152.4	0.04	1.36
SPU13-110	63.55	50	13	110	75	180.4	0.04	1.76
SPU16-125	63.55	57	16	125	80	190.4	0.04	2.18
SK50- SPU8-75	97.50	37	8	75	55	185.75	0.04	4.10
SPU13-100	97.50	50	13	100	75	213.75	0.04	4.50
SPU16-105	97.50	57	16	105	80	218.75	0.04	4.78

注：報價時含扳手。
Notice: Wrench is included.

SK-FMB Face Milling Holder
SK-FMB平面銑刀柄

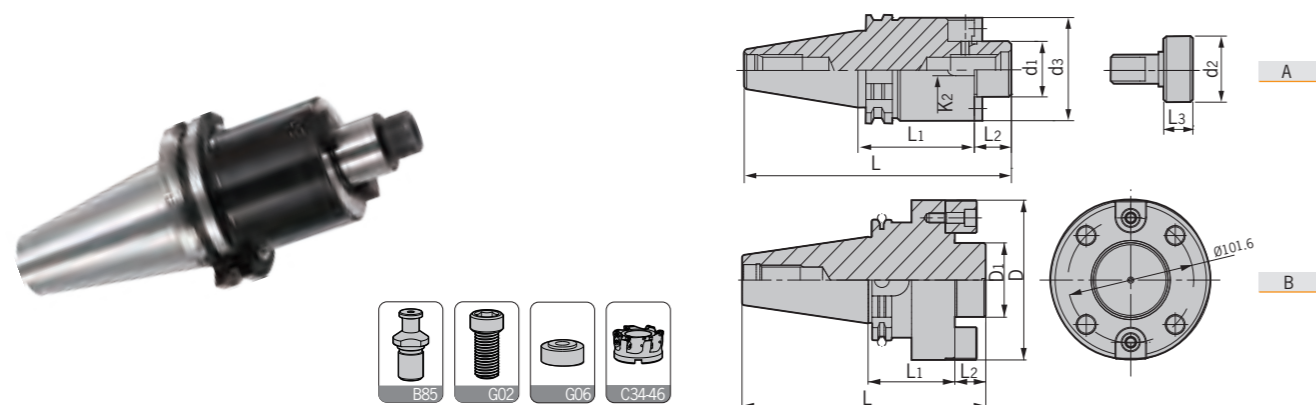

型號 Specification	圖示 Figure	d ₁	d ₂	d ₃	L ₁	L ₂	L ₃	L	刀盤鎖緊螺釘 Lockingscrewfor cutter	墊圈 Washer	重量 Weight
SK30- FMB22-35	A	22	26	47	35	18	14	100.8	E100U300	-	0.70
FMB27-35	A	27	33	58	35	20	16	102.8	E120U300	FM-1	1.00
SK40- FMB22-35	A	22	26	47	35	18	14	121.4	E100U300	-	1.20
FMB27-60	A	27	33	58	60	20	16	148.4	E120U300	FM-1	1.86
FMB32-60	A	32	40	66	60	22	16	150.4	E160U350	FM-2	2.32
FMB40-60	A	40	50	82	60	25	20.5	153.4	E200U350	FM-3	2.47
SK50- FMB22-35	A	22	26	47	35	18	14	154.75	E100U300	-	3.60
FMB27-35	A	27	33	58	35	20	16	156.75	E120U300	FM-1	3.79
FMB32-35	A	32	40	66	35	22	16	158.75	E160Z350-40	-	4.10
FMB40-50	A	40	50	82	50	25	20.5	189.75	E200Z350-50	-	4.57
FMB60F-70	B	60	-	129	70	25	-	211.75	E160U500	-	8.00

SLO/CSO/PB

SK-SLO Oil-feed Holder
SK-SLO油路刀柄

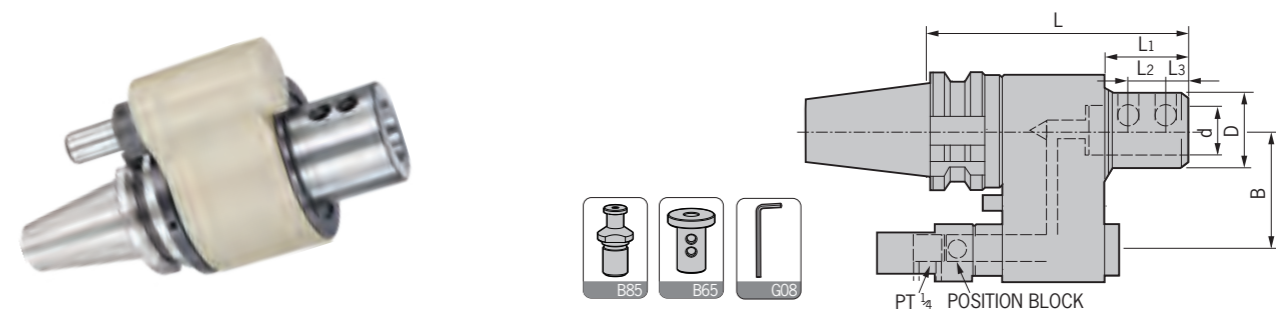

型號 Specification	D	d	L ₁	L ₂	L ₃	L	B	側面壓緊螺釘 Side-lock screw	重量 Weight
SK40- SLO32-150	72	32	50	15	15	150	60/65	M120U200	5.35
SLO40-150	72	40	50	18	19	150	60/65	M140U160	5.04
SK50- SLO32-160	72	32	50	15	15	160	80/82	M120U200	8.64
SLO40-160	72	40	50	18	19	160	80/82	M140U160	8.35

注：報價時含扳手，請於訂購時，依據機臺規格確認中心距離B的尺寸。
Notice: 1. Wrench is included; 2. Before order please check the distance B.

CSO Oil-feed Holder Reducing Sleeve
CSO油路刀套

型號 Specification	D	d	d ₁	L ₁	L ₂	L ₃	L	重量 Weight
CSO 32-16	53	32	16	10	15	15	65	0.40
32-20	53	32	20	10	15	15	65	0.35
32-25	53	32	25	10	15	15	65	0.26
40-16	63	40	16	10	18	19	75	0.74
40-20	63	40	20	10	18	19	75	0.68
40-25	63	40	25	10	18	19	75	0.59
40-32	63	40	32	10	18	19	75	0.41

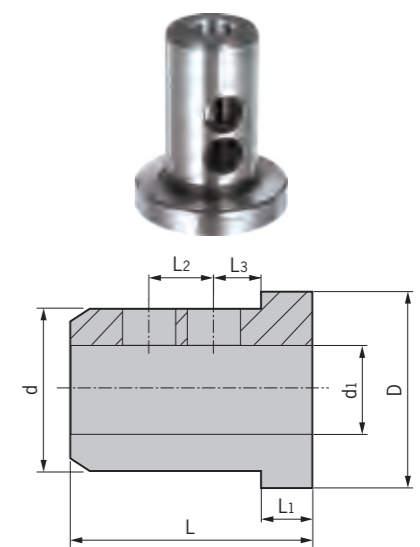

PB Oil-feed Holder Positioning Block
PB油路止動塊

型號 Specification	重量 Weight
BT40-PB30-35	0.53
BT50-PB30-35	0.46

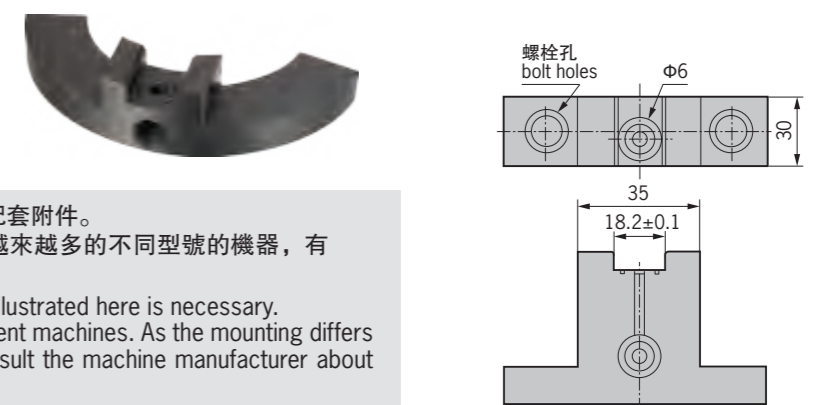

注意：在使用油路刀柄時，止動塊是必需的配套附件。
止動塊可安裝到ATC等機器上。因此，隨着越來越多的不同型號的機器，有必要與機械製造商協商正確安裝。

Notice: Using oil-feed holder, positioning block illustrated here is necessary.
This positioning block can be mounted to different machines. As the mounting differs with different machines, it is necessary to consult the machine manufacturer about the proper mounting.